

Client name: XX  
Address: XX  
Date: XX

Landstylist Notes

## [Pinterest Board Link](#)

### 1. **Assessment of existing conditions:**

400 sq foot terrace in large Condo Building-- Southwest facing

**A. Paving, materials, and furniture:** Existing paving—fencing to be replaced, no furniture currently.

**B. Plants:** none currently

**C. Light and wind conditions:** Southwest facing, very sunny, very exposed

**D. Soil conditions/in ground vs planter/quality of existing soil:** Requires planters.

**E. Characteristics of site (building by-laws, weight, water use requirements, neighbor issues, soil):** Will need to verify weights with Architect/Engineer to confirm loads can be tolerated with planters—**paving and soil loads wet and dry. Should have roof surface inspected if new paving is installed to make sure in good condition. Flashing should be repaired.**

Will require an irrigation system for linear planters and pots.

**F. Access issues (access to water, elevator size & accessibility):** Elevator access to 5<sup>th</sup> floor and then one flight of stairs from 5<sup>th</sup> to 6<sup>th</sup> floor within apartment. Access to water source on terrace.

### 2. **Client preferences**

**A. General aesthetic/ inclination:** Space for entertaining large and small groups, area [for 'Green Egg BBQ'](#) lounging, dining, maintenance, highline inspired plantings,

**B. Budget:** 20k to start, phased over time.

**C. Plant preferences/colors (if any):** Low maintenance, likes highline, wild look, mix between evergreen and perennials, roses, orange and yellow perennials.

**D. Degree of privacy, neatness:** Relatively private, views from common spaces from above



Client name: XX  
 Address: XX  
 Date: XX

Landstylist Notes

### 3. Going Forward: Recommendations

Inspection and Permits: Recommendation to check with building regarding loads. If replacing paving, have inspection of roof membrane and repairs to flashing in advance.

Need to have sign-off on loads from Condo Board

Paver Recommendations: [Natural Stone](#) or [Concrete Pavers](#)

#### KEY- Please refer to Plant list p.4 + Plan p.5

**A. South Planters-** Fiberglass linear planters L48" x 16" x 16" Climbing Roses mixed with Calamagrostis and Nepeta.

**B. West Planters-** Length 48 x W24" x H16" lined up at base of parapet, planted with Virginia Creeper vines to green fence, Boxwood mixed with Calamagrostis, Aesclepias, Helenium, Yarrow, Russian Sage, and Nepeta

**C. Select 'Clear' Cedar fence horizontal slats (no knots):** Fence along West and North Side of Terrace to screen Neighbors. With ½" gaps

**C: Fiberglass planters:** Length TBD x width 18" x Height TBD (height depends on bench backing detail)

**D. Planters: L TBD x W10" x H12" mounted with fiberglass planters:**

Planted with English ivy to drape and soften brick wall.

**E. Grouping of Three round Pots: West Elm or similar**

**Large round planter: 36" Diameter-** Japanese Maple or Paperbark Birch planted with Autumn Moor Grass @base.

**Medium round planter: 24"-** Autumn Moor Grass mixed with rosemary, thyme, salvia.

**Small Round Planter- 16" diameter**

**Herb garden:** Rosemary, oregano, basil, lavender

**F. Medium Round Planter 24" dia:** placed at base of support for trellis.

Planted with Wisteria to grow and soften trellis overhead.

**G. Trellis:** Either wood cantilevered from building, or off -the -shelf aluminum trellis to provide shade.



Client name: XX  
Address: XX  
Date: XX

Landstylist Notes

## H. Furnishings (dimensions TBD –layout on site)

### Options:

1. L-shaped Sofa- dimensions TBD
2. Coffee table
3. Accent chair: Rope or mesh
4. [BBQ](#)
5. Dining Table
6. Dining chairs rope or mesh

### Resources

Planters:

[Planter Resource:](#)

[Pennoyer Neuman](#)

[Campania](#)

[Teak Warehouse](#)

[West Elm](#)

### Furniture:

[Article](#)

[DWR](#)

[Fermob](#)

[West Elm](#)

[Lulu and Georgia](#)

### Landscape Lighting:

In Planters

linear planters @perimeter

[Lumien](#) light on stake OR

[Fx Brilliance](#)



Client name: XX  
 Address: XX  
 Date: XX

Landstylist Notes

**Plants:**

**Shrubs**

[Boxwood 'Green Mountain'](#)

**Grasses**

[Calamagrostis 'Karl Foerster'](#)

[Autumn Moor Grass](#)- good in partial shade, lower grass

**Flowering Perennials:**

[Russian Sage](#)

[Red Midget Prairie Coneflower](#)

[Yarrow](#)

[Nepeta](#)

[Aesclepias](#)

[Helenium](#)

[Salvia](#)

**Vines:**

[English Ivy](#)

[Virginia Creeper](#)- West side plant @base of fence

[Honeysuckle](#)- train to climb railings

[Climbing Roses](#)- South Side train to climb railings( be sure to plant roses with Rosetone, bone meal and organic compost for best result)

**Herbs:**

Lavender

Basil

Thyme

Rosemary

**Contractors/Designers/Horticulturalists:**

[BlueplantNYC](#): Contact Michael Franco

[Shape Gardens](#): Contact: George

Carpentry, Paving, Planting, Irrigation and Lighting

[Digitnyc](#): Specializes in planting, lighting and irrigation.



Client name: XX  
Address: XX  
Date: XX

Landstylist Notes

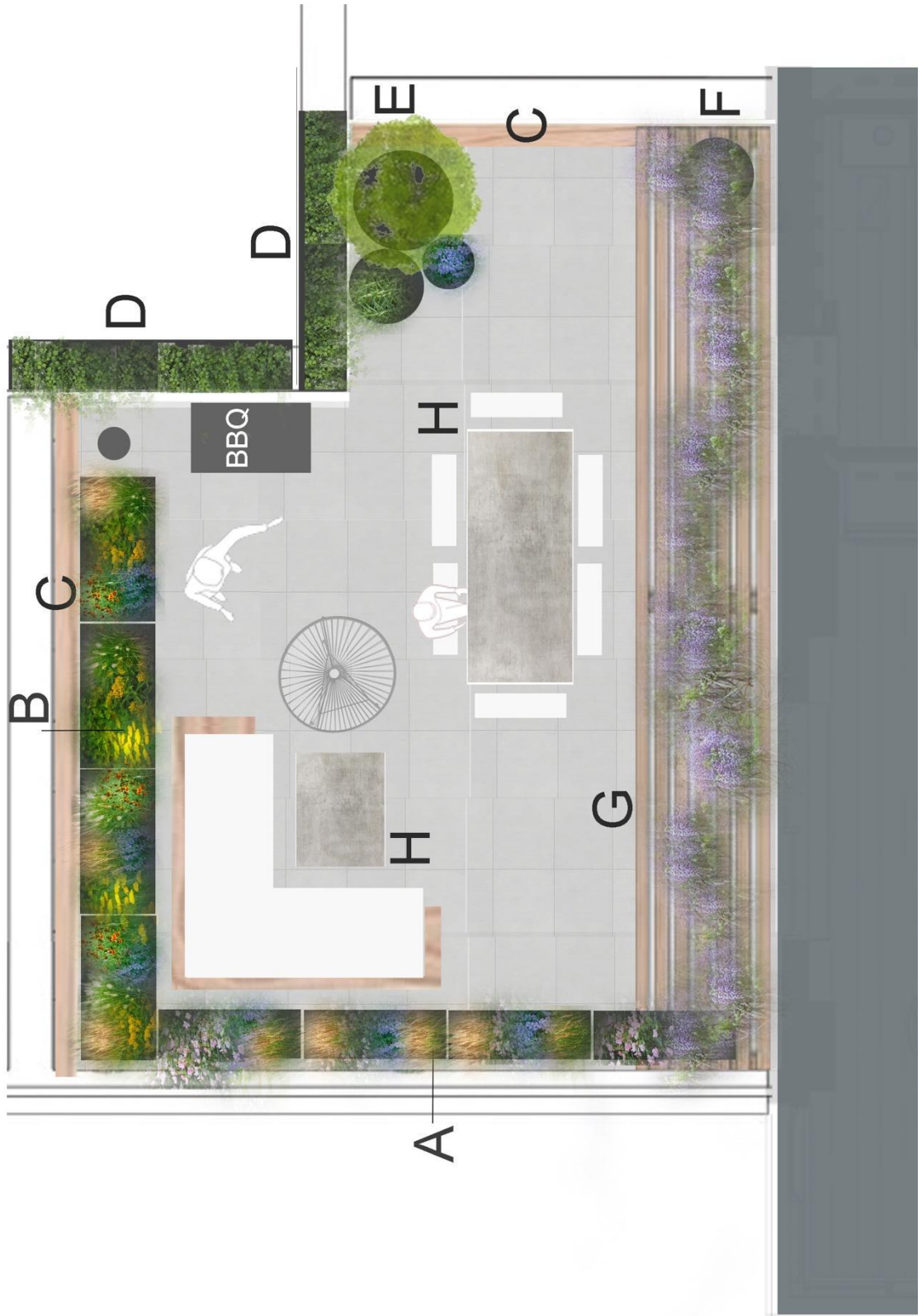



Client name: XX  
Address: XX  
Date: XX

Landstylist Notes

